

FREEMAN MARINE 1130 Premium Duty panel doors feature a knife-edge seal, robust gasket and floating hinges to provide a premium watertight seal when properly adjusted and dogged closed.** Thick panel skins, extra internal reinforcements, no exposed seams and all welded construction create a seamless, premium, individually dogged door. When specified with optional yacht-quality paint to your color specifications, the 1130 Series welded construction results in a smooth, seamless appearance that provides long lasting beauty. Premium panel doors offer welded-in windows and can accommodate special glazing. Premium Panel doors are suitable for:

- Transoms • Below Deck Bulkheads
- Engine Room • Machinery Spaces • Storage

PREMIUM PANEL DESIGN FEATURES

- Custom Sizing, width and height
- .160" ~ .250" Thick Aluminum Panel Skins
- Welded Frame and Skin Construction
- Gasket on Door Panel for Long Life and Positive Sealing
- Knife-edge Sealing Method
- Radius Corners
- Bolt-in, Weld-in or Clamp-in Frames
- Additional Internal Stiffeners
- Lineal Sanded Finish
Yacht-quality painted finish (avail)
- Stainless Steel Dog Shafts
- Cast Aluminum Handles, powder coat (opt avail)
- Glass Filled Striker Wedges
- Solid Insulation (opt materials avail)
- Surface and Concealed Hinges (avail)
- Stainless Steel Fasteners
- Welded In Window, glazing and tint (opt avail)



7" view port, Access to bow thruster



Knife-edge seal, Panel mounted gasket



Dog/handle detail

** Degree of watertightness depends on number of dogs, proper installation and sealing adjustment. Watertight doors are individually defined, specified and fabricated for each application.



Access door, 7" view port,
Painted dogs, Interior



Access door, 7" view port,
Painted dogs, Exterior



Six dogs,
7" view port,
Deep gutter
coaming



7" view port,
With tempered
glass retainer



Four dogs,
View port, Closed



Four dogs,
View port, Open



Six dogs,
7" view port,
Blade hinges



Six dogs,
7" view port,
Coaming for
bolt-in installation



Hinge,
Aluminum blade,
Weld-on



Access door, Bare metal,
Steel coaming, Closed (above);
Open (right)



Six dogs,
7" view port, Roller
cam, Individual
dogs

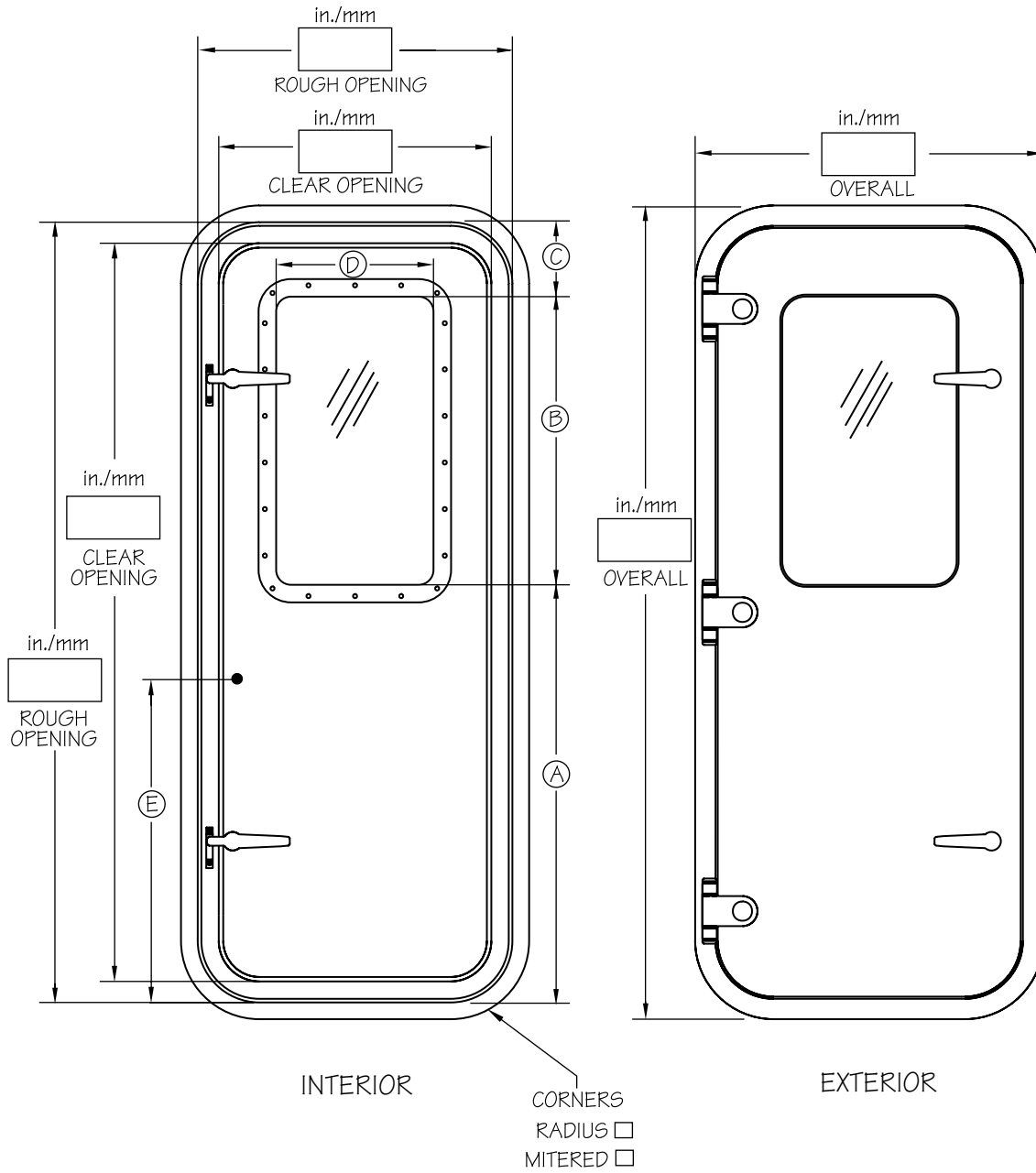

**LAYOUT
MODEL 1130**

inches		mm	Dimensions For Options
A			Bottom of Clear Glass to Bottom Rough Opening
B			Clear Glass Height
C			Top of Clear Glass to Top of Rough Opening, min 7"
D			Clear Glass Width, min side clearance 6"
E			Handle/Lockset - C/L to Bottom Rough Opening

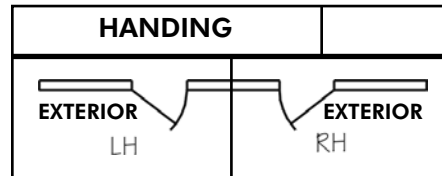

Scale	None
--------------	------

© ALL RIGHTS RESERVED
2010 FREEMAN MARINE EQUIPMENT, INC.
SPECIFICATIONS SUBJECT TO CHANGE WITHOUT NOTICE

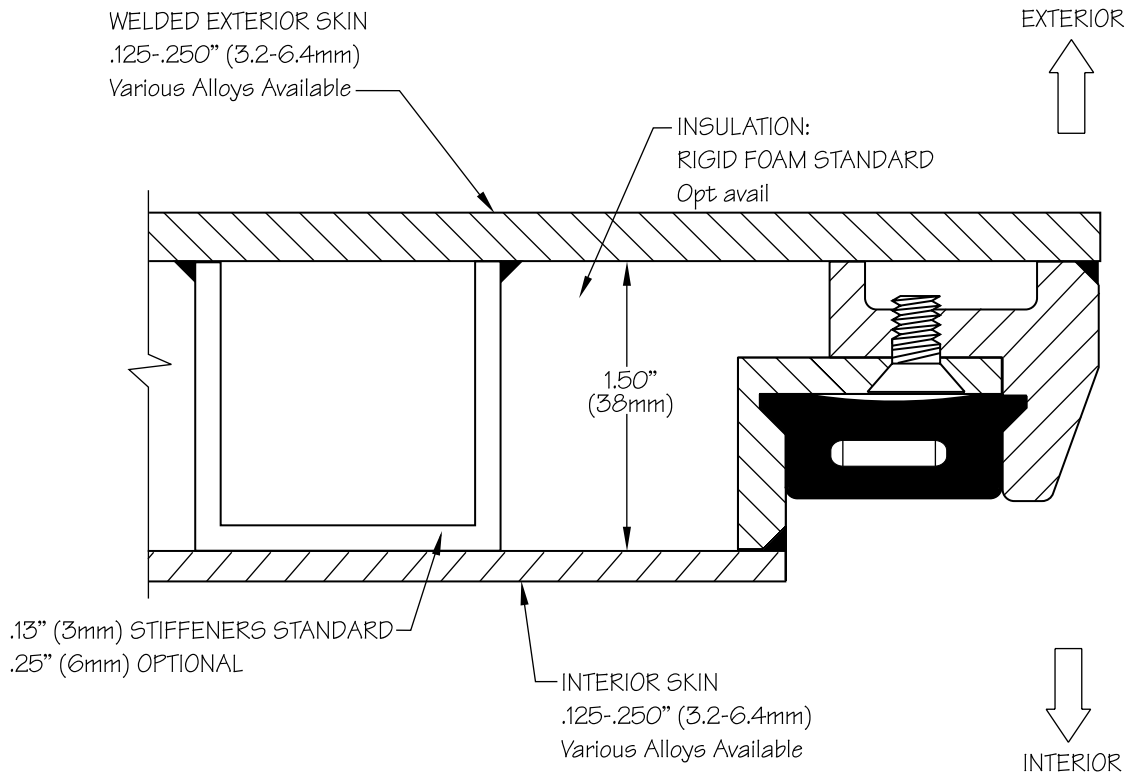
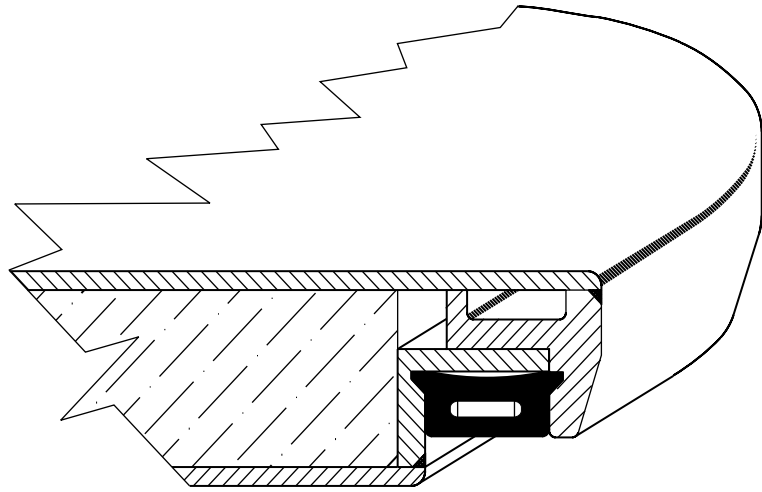

PANEL

Sealing Performance	Watertight		
Availability	1130 Single	1430 Quick-Acting	1530 Dutch

Degree of watertightness depends on panel and coaming construction, number of dogs, proper installation and sealing adjustment. Closures are individually defined, specified and fabricated for each application.

© ALL RIGHTS RESERVED
2010 FREEMAN MARINE EQUIPMENT, INC.
SPECIFICATIONS SUBJECT TO CHANGE WITHOUT NOTICE

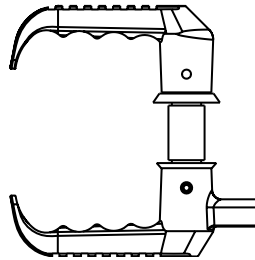
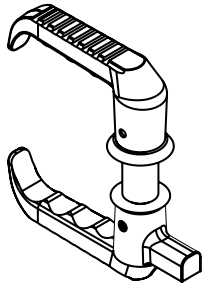

NO BEARING

Available on Door: 1110
1120
1130
1510
1520
1610
1620

Handle Material: Aluminum
Stainless Steel
Shaft: Stainless Steel

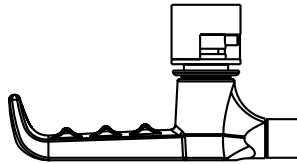
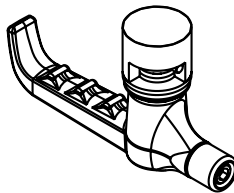

INSIDE DOG ONLY, NO BEARING
no outside dog

Available on Door: 1120
1130
1520
1620

Handle Material: Aluminum
Stainless Steel
Shaft: Stainless Steel

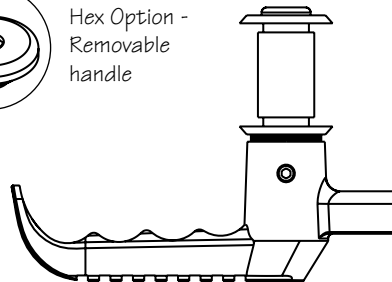
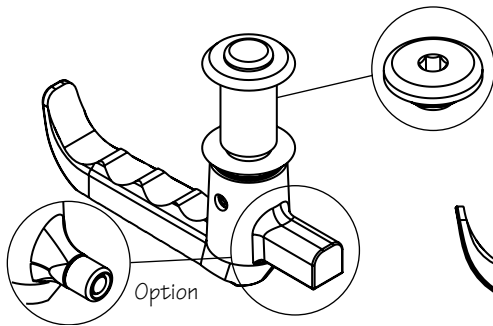

INSIDE DOG ONLY, NO BEARING
no outside dog - outside spindle head visible

Available on Door: 1120
1130
1510
1520
1610
1620

Handle Material: Aluminum
Stainless Steel
Shaft: Stainless Steel

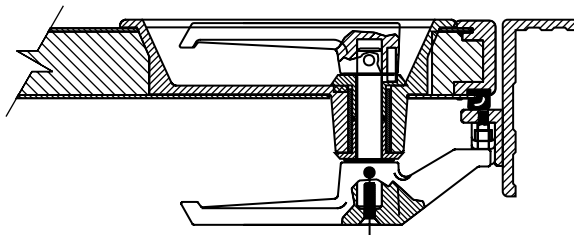

FLUSH, NO BEARING
outside and inside

Available on Door: 1110
1120
1130
1510
1520
1610
1620

Handle Material: Aluminum
Shaft: Stainless Steel

Scale None

© ALL RIGHTS RESERVED
2010 FREEMAN MARINE EQUIPMENT, INC.
SPECIFICATIONS SUBJECT TO CHANGE WITHOUT NOTICE

HANDLES

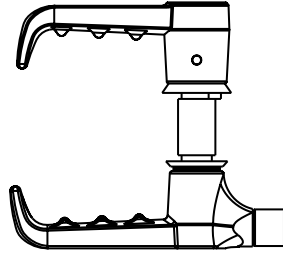
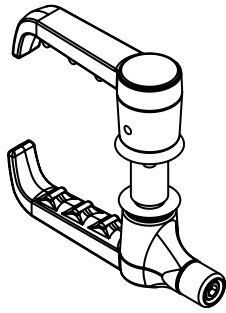

CAM FOLLOWER

Available on Door: 1110
1120
1130
1510
1520
1610
1620

Handle Material: Aluminum
Shaft: Stainless Steel

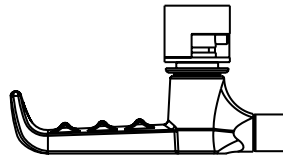
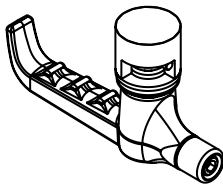

INSIDE DOG ONLY, CAM FOLLOWER

no outside dog

Available on Door: 1120
1130
1520
1620

Handle Material: Aluminum
Shaft: Stainless Steel

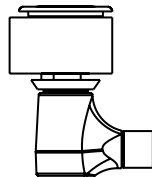
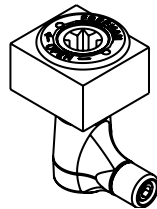

BI-SQUARE OUTSIDE / DOG INSIDE, CAM FOLLOWER

Available on Door: 1120
1130
1520
1620

Handle Material: Aluminum
Stainless Steel
Shaft: Stainless Steel

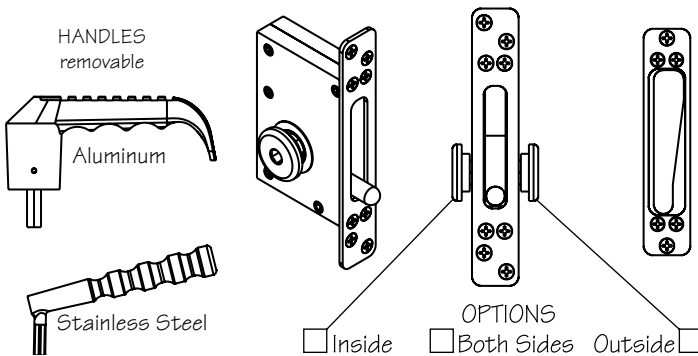

CONCEALED, EDGE-OF-PANEL

Available on Door: 1120
1520
1620

Concealed Handle Material: Stainless Steel
Handle Material: Aluminum
Stainless Steel
Shaft: Stainless Steel

Scale None

© ALL RIGHTS RESERVED
2010 FREEMAN MARINE EQUIPMENT, INC.
SPECIFICATIONS SUBJECT TO CHANGE WITHOUT NOTICE

HANDLES

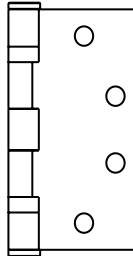
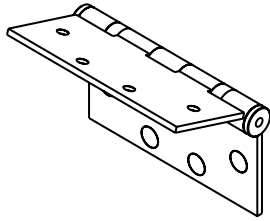

BUTT HINGE
adjustable stop coamings
4.5" x 4.5", 6.0" x 4.5", 8.0" x 6.0"

Available on Door: 1110
1120
1420
1510
1520
1610
1620

Finishes Available: Polished
Satin

Material: Stainless Steel

Attachment: Bolt-on

(1X10 series requires butt hinge)

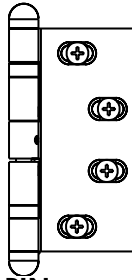
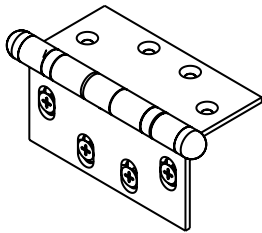

BUTT HINGE, WITH DOME PIN
fixed or adjustable stop coamings
4.5" x 4.5"

Available on Door: 1120
1420
1520
1620

Finishes Available: Polished

Material: Stainless Steel

Attachment: Bolt-on

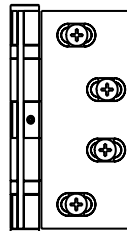
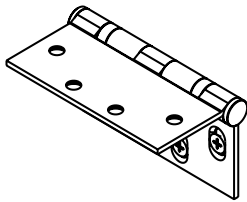

BUTT HINGE
fixed stop or adjustable stop coamings
4.5" x 4.5"

Available on Door: 1110
1120
1420
1510
1520
1610
1620

Finishes Available: Polished
Satin

Material: Stainless Steel

Attachment: Bolt-on

(1X10 series requires butt hinge)

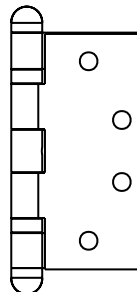
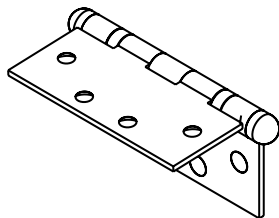

BUTT HINGE, WITH DOME PIN
adjustable stop coamings
4.5" x 4.5", 6.0" x 4.5", 8.0" x 6.0"

Available on Door: 1120
1420
1520
1620

Finishes Available: Polished

Material: Stainless Steel

Attachment: Bolt-on

Scale None

© ALL RIGHTS RESERVED
2010 FREEMAN MARINE EQUIPMENT, INC.
SPECIFICATIONS SUBJECT TO CHANGE WITHOUT NOTICE

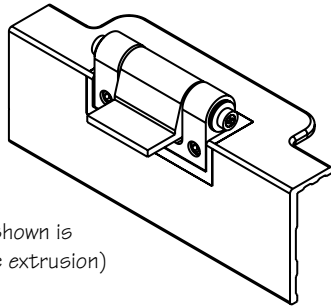

(Hinge shown is in flange extrusion)

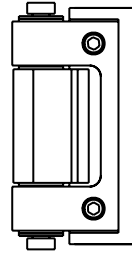

FLUSH HINGE

Available on Door: 1120
1130
1420
1430
1432
1520
1620

Finishes Available: Painted
Vibratory

Material: Aluminum

Attachment: Weld-on

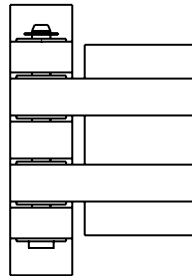
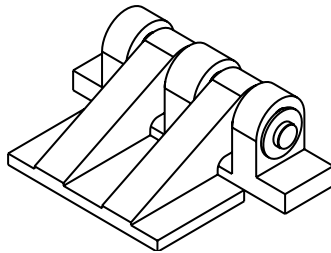

BLADE HINGE

Available on Door: 1120
1130
1420
1430
1432
1520
1620

Finishes Available: Painted
Vibratory

Material: Aluminum

Attachment: Weld-on
Bolt-to-coaming

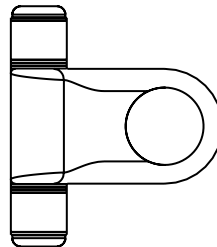
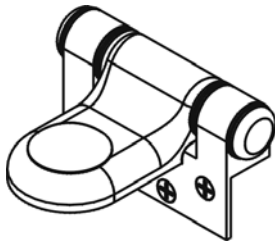

EURO HINGE

Available on Door: 1120
1130
1420
1430
1432
1520
1620

Finishes Available: Painted
Vibratory

Material: Aluminum

Attachment: Bolt-on

NOTE: Yoke hinges remain in clear opening space even though door panel swings completely out of opening. Maximum opening 97°.

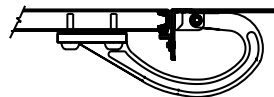
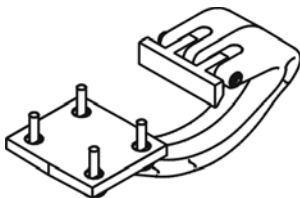

YOKE HINGE (Concealed)

universal, with rubber bumpers

Available on Door: 1120
1130
1420
1430
1432
1620

Finishes Available: Polished
Painted
Vibratory

Material: Aluminum

Attachment: Bolt-on

Scale None

© ALL RIGHTS RESERVED
2010 FREEMAN MARINE EQUIPMENT, INC.
SPECIFICATIONS SUBJECT TO CHANGE WITHOUT NOTICE